

A slope cross fitting, used on sloping guardrail between 0° and 11°. Typical used to connect the mid/lower rail to the vertical. It is normally used in conjunction with KC155 when building a 2 or 3 rail guardrail. This clamp does not allow tubes to be joined within the fitting.

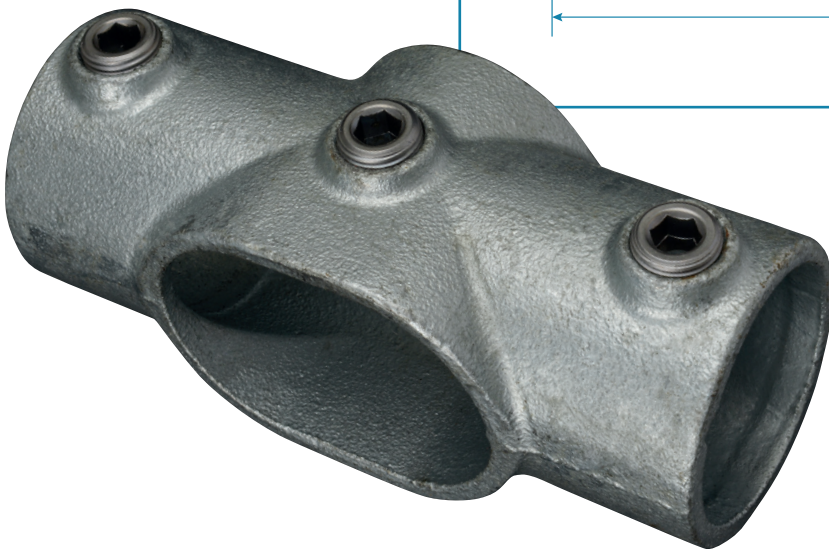
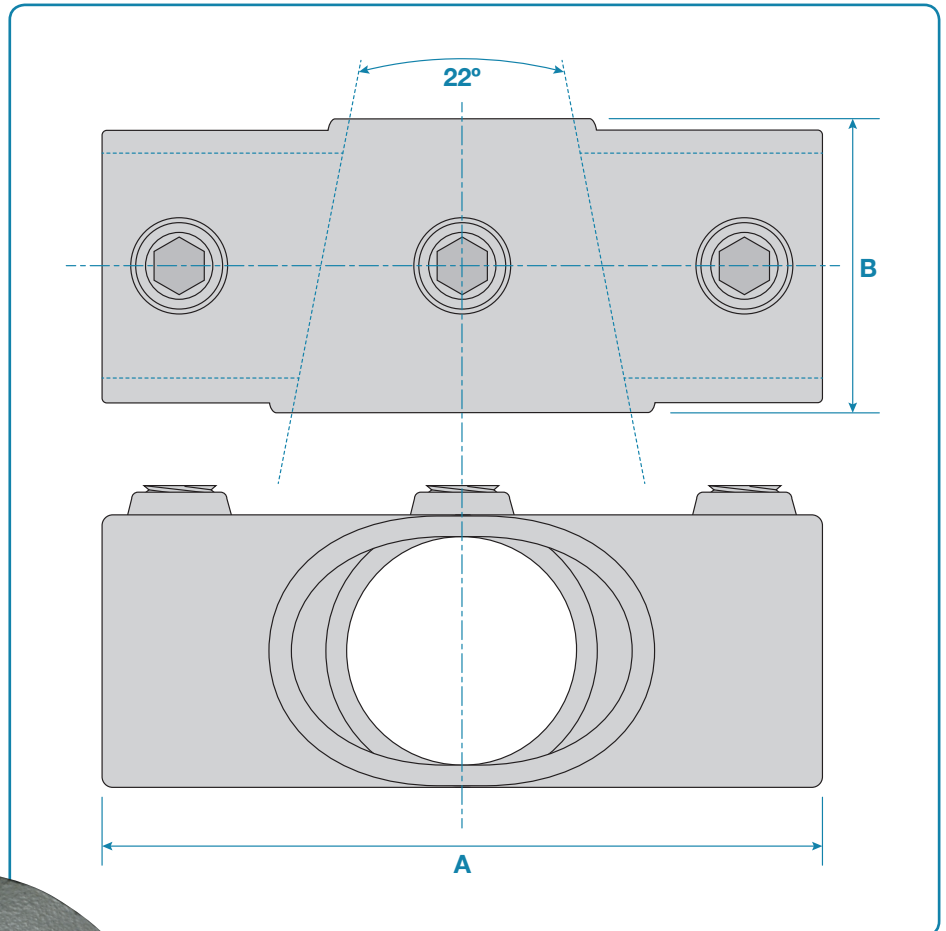

Code	A	B	Weight
KC156C	142mm	71mm	0.75kg
KC156D	160mm	80mm	0.98kg