

A sloping down tee fitting designed for top rail on slopes & staircases between 30° to 45° at the junction where the handrail changes from level to sloping down.

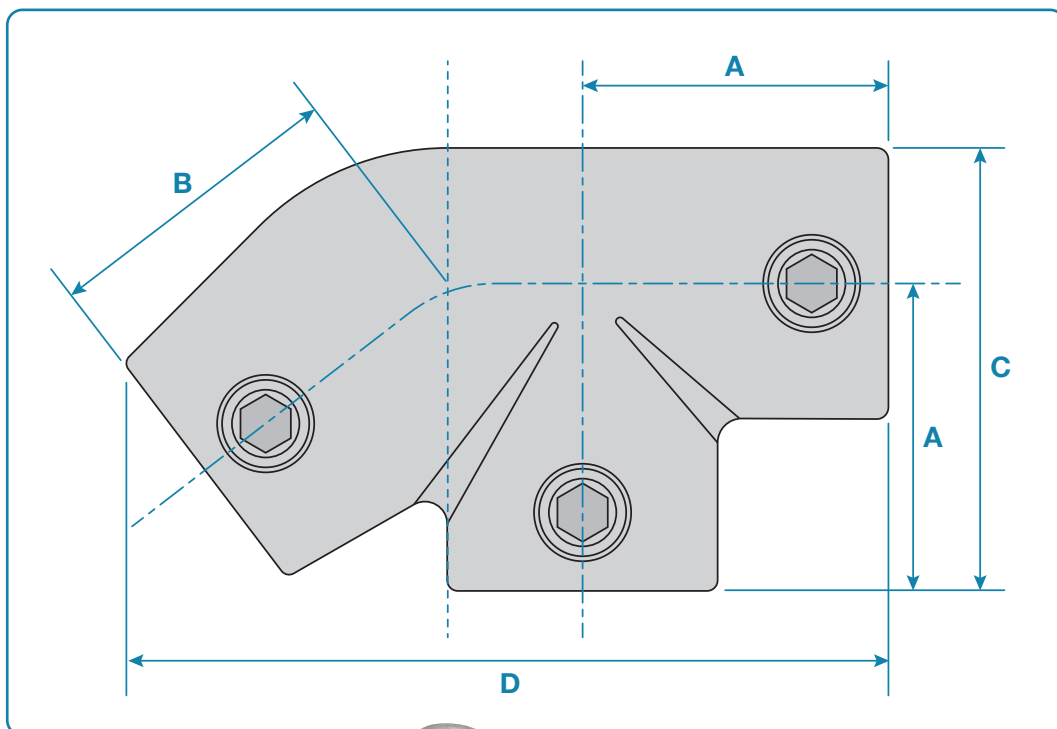

**Please Note:** Dimensions for guide only. Components may vary slightly from the sizes shown.

Updated: 09-06-2025

Code	A	B	C	D	Weight
<b>KC325C</b>	60mm	56mm	85mm	145mm	0.89kg
<b>KC325D</b>	68mm	65mm	100mm	170mm	1.18kg

DC Handrails & Ironwork Parts Ltd,  
3 Whickham Industrial Estate, Swalwell, Newcastle upon Tyne, NE16 3DA

[dciron.co.uk](http://dciron.co.uk)