

A single swivel combination fitting, the swivel has a travel of approximately 85° from the horizontal in both vertical directions. This fitting combines a KC173M and a KC173F. This clamp does not allow tubes to be joined within the fitting. THIS CLAMP IS NOT DESIGNED TO WITHSTAND LATERAL LOADS.

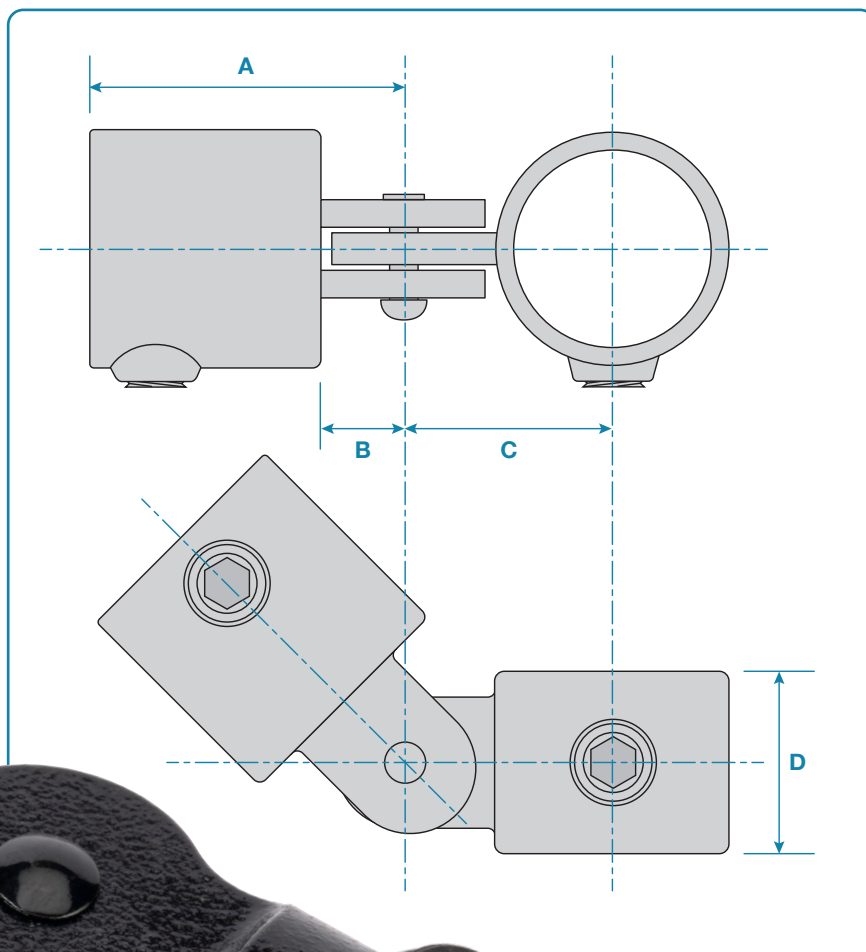

Please Note: Dimensions for guide only. Components may vary slightly from the sizes shown.

Updated: 06-05-2025

Code	A	B	C	D	Weight
KCE173A	60mm	22mm	39mm	38mm	0.45kg
KCE173B	72mm	22mm	44mm	39mm	0.58kg